

# CLOUDVOTE WEB APP TUTORIAL

PARTICIPANT TIPS



# CLOUDVOTE ACCOUNT

LOG INTO A CLOUDVOTE SESSION



# CLOUDVOTE ACCOUNT

- As a Participant, log into an active CloudVOTE session here:

**[joincloudvote.com](http://joincloudvote.com)**

- Other shortcuts:
  - [mycloudvote.com](http://mycloudvote.com) (a more generic URL)
  - [cloudvote.com/join](http://cloudvote.com/join) (Participant/Attendee login)



# CLOUDVOTE SESSION

- Enter an Event/Join Code for the session that you want to vote in
  - This would have been given to you by the organizer/presenter.
  - Event/Join Code is **NOT** case sensitive.
  - Spaces before and after the code will be ignored.



## Join Session

© 2023 - Meridia Interactive Solutions - 3.6.8703.19912

# CLOUDVOTE SESSION

- If this is an anonymous session and you entered a correct Join/Event Code, you will see the first slide of the session content.



Logged in as: G74K

**TOWNVOTE**



# CLOUDVOTE SESSION

- If the session organizer requires more personal information, you will see a second login screen.
  - List of fields may be different.
  - You cannot log in from multiple devices at the same time.
  - However, you can close one browser and open another a couple of seconds later.



The organizer has requested some additional information before entering.

First Name

Last Name

Unique ID \*

Start to Join

# CLOUDVOTE SESSION

- If you have entered incorrect login information (only the **required** fields matter), you will need to be approved by the Operator.



**Please wait until operator verifies your data.**

# CLOUDVOTE SESSION

- If your login couldn't be verified, you will be redirected to the login page, where you can try to log in again.
  - Required information is **NOT** case sensitive.
  - Spaces before and after are ignored.



**Operator couldn't verify your login.  
Go back, double-check your spelling  
and try again, or contact your  
meeting organizer.**

**Redirecting to Participant Information submit  
page in 1 seconds...**



# CLOUDVOTE ACCOUNT

HOW TO VOTE



# HOW TO VOTE

- When polling is open, you will see available options as buttons under the slide thumbnail
- Vote according to the rules displayed on your screen

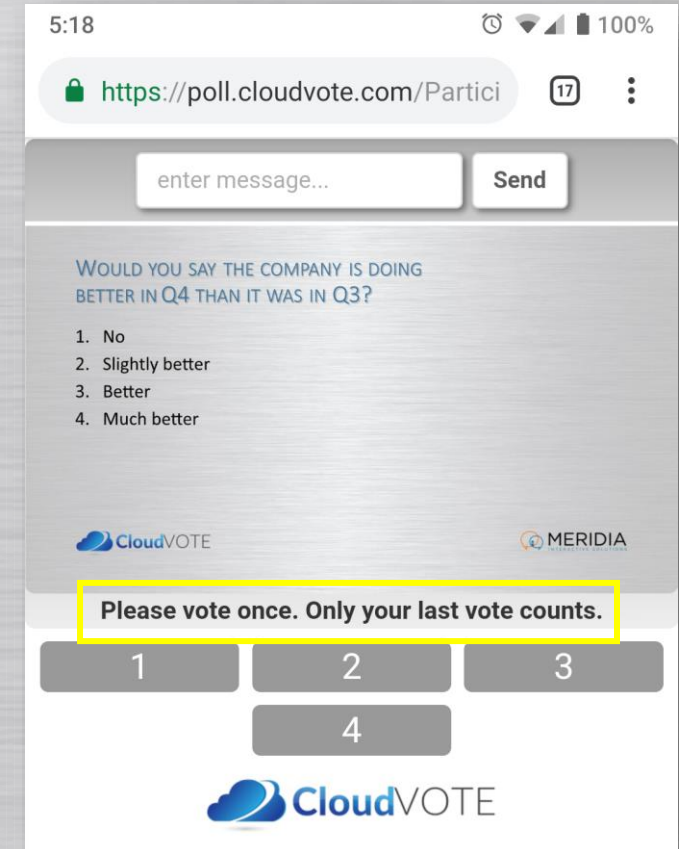
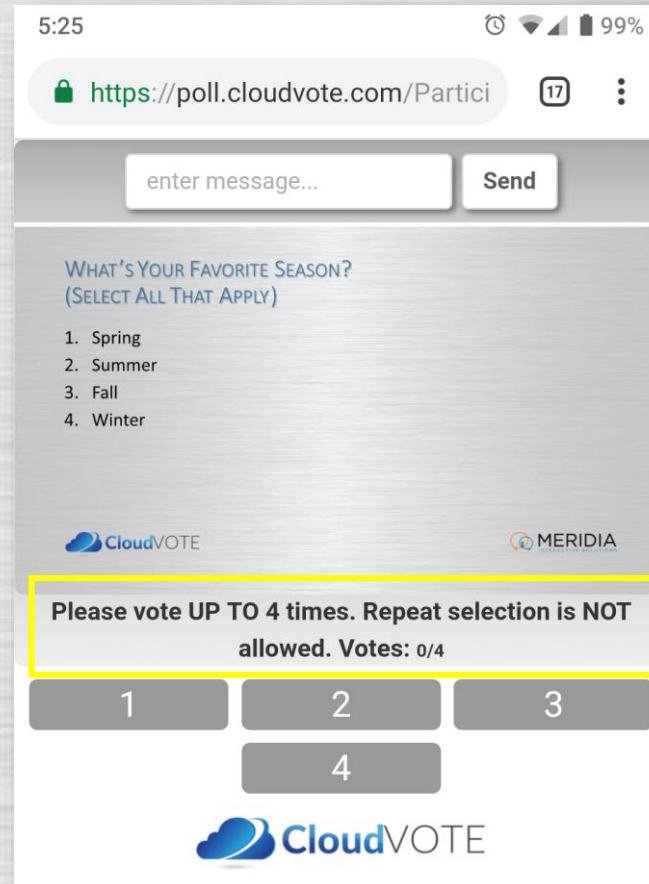

# HOW TO VOTE

- Your vote is confirmed each time you submit it
- ...even when you're just changing your mind

A screenshot of a mobile web browser displaying a poll. At the top, the status bar shows the time 5:19, signal strength, Wi-Fi, and 100% battery. The address bar shows the URL "https://poll.cloudvote.com/Partici". A notification box at the top of the page reads "Vote has been received successfully" and is highlighted with a yellow border. Below the notification, the poll question is "WOULD YOU SAY THE COMPANY IS DOING BETTER IN Q4 THAN IT WAS IN Q3?". The poll options are: 1. No, 2. Slightly better, 3. Better, 4. Much better. At the bottom, there are four buttons labeled 1, 2, 3, and 4. Button 2 is highlighted in blue, indicating it is the selected option. The CloudVOTE logo is at the bottom center, and the MERIDIA logo is at the bottom right. A banner at the bottom of the poll area says "Please vote once. Only your last vote counts."/>

5:19 100%

<https://poll.cloudvote.com/Partici>

Vote has been received successfully

WOULD YOU SAY THE COMPANY IS DOING BETTER IN Q4 THAN IT WAS IN Q3?

1. No
2. Slightly better
3. Better
4. Much better

Please vote once. Only your last vote counts.

1 2 3 4

CloudVOTE MERIDIA

CloudVOTE

# HOW TO VOTE

- On a multi-vote slide, vote as many times as the slide rules allow
- Change your mind by de-selecting the previous answer first, then choosing a new answer

